

GCDB Series

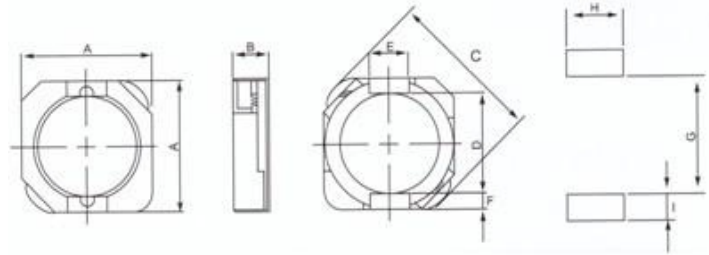

● Dimensions and Land Patterns. (UNIT: mm)



● Applications:

Notebook, Desktop, Modem equipment,
LCD,OA equipment, other electronic equipment

● Operating temperature: -40 °C to +125 °C

TYPE	A (max)	B (max)	C (max)	D	E	F	G	H	I
GCDB103	10.50	3.10	13.50	7.70	3.00	1.20	7.30	3.20	1.60
GCDB104	10.50	4.00	13.50	7.70	3.00	1.20	7.30	3.20	1.60
GCDB105	10.50	5.10	13.50	7.70	3.00	1.20	7.30	3.20	1.60

● Part Numbering

GCDB 103 M T 100

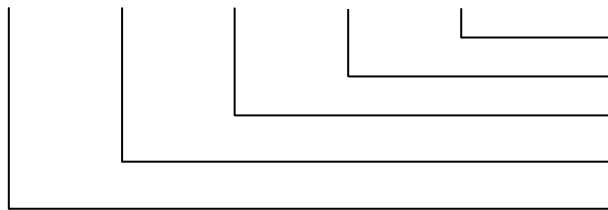

Inductance Value: 100:10uH
Packaging Code: Taping Reel
Inductance Tolerance: N:±30% M: ±20%
Dimensions: 103 104 105
Product Type

Electrical characteristics List

GCDB103 Series

PART No.	L(uH)	Tolerance	Test Condition	DCR (Ω)MAX	IDC (A)
GCDB103NT1R2	1.2	N	100KHZ/0.25V	0.012	4.80
GCDB103NT1R8	1.8	N	100KHZ/0.25V	0.014	4.50
GCDB103NT2R7	2.7	N	100KHZ/0.25V	0.018	4.10
GCDB103NT3R9	3.9	N	100KHZ/0.25V	0.022	3.76
GCDB103NT6R8	6.8	N	100KHZ/0.25V	0.036	3.10
GCDB103NT8R2	8.2	N	100KHZ/0.25V	0.042	3.00
GCDB103MT100	10	M	1KHZ/0.25V	0.052	2.80
GCDB103MT150	15	M	1KHZ/0.25V	0.062	2.10
GCDB103MT220	22	M	1KHZ/0.25V	0.091	1.80
GCDB103MT330	33	M	1KHZ/0.25V	0.150	1.53
GCDB103MT470	47	M	1KHZ/0.25V	0.208	1.34
GCDB103MT560	56	M	1KHZ/0.25V	0.228	1.19
GCDB103MT680	68	M	1KHZ/0.25V	0.289	1.13
GCDB103MT820	82	M	1KHZ/0.25V	0.312	1.04
GCDB103MT101	100	M	1KHZ/0.25V	0.377	0.960
GCDB103MT121	120	M	1KHZ/0.25V	0.449	0.882
GCDB103MT151	150	M	1KHZ/0.25V	0.607	0.747
GCDB103MT181	180	M	1KHZ/0.25V	0.676	0.688
GCDB103MT221	220	M	1KHZ/0.25V	0.826	0.666
GCDB103MT271	270	M	1KHZ/0.25V	0.933	0.580
GCDB103MT331	330	M	1KHZ/0.25V	1.14	0.513
GCDB103MT391	390	M	1KHZ/0.25V	1.43	0.490
GCDB103MT471	470	M	1KHZ/0.25V	1.61	0.450

Electrical characteristics List

GCDB104 Series

PART No.	L(uH)	Tolerance	Test Condition	DCR (Ω)MAX	IDC (A)
GCDB104NT1R2	1.2	N	100KHZ/0.25V	0.0155	5.40
GCDB104NT1R8	1.8	N	100KHZ/0.25V	0.016	5.20
GCDB104NT2R2	2.2	N	100KHZ/0.25V	0.017	4.95
GCDB104NT2R7	2.7	N	100KHZ/0.25V	0.020	4.50
GCDB104NT3R3	3.3	N	100KHZ/0.25V	0.022	4.35
GCDB104NT3R9	3.9	N	100KHZ/0.25V	0.026	4.05
GCDB104NT4R7	4.7	N	100KHZ/0.25V	0.028	3.90
GCDB104NT5R6	5.6	N	100KHZ/0.25V	0.033	3.80
GCDB104NT6R8	6.8	N	100KHZ/0.25V	0.043	3.50
GCDB104NT8R2	8.2	N	100KHZ/0.25V	0.050	3.20
GCDB104MT100	10	M	1KHZ/0.25V	0.060	3.15
GCDB104MT150	15	M	1KHZ/0.25V	0.078	2.90
GCDB104MT220	22	M	1KHZ/0.25V	0.107	2.50
GCDB104MT270	27	M	1KHZ/0.25V	0.114	2.30
GCDB104MT330	33	M	1KHZ/0.25V	0.133	2.00
GCDB104MT390	39	M	1KHZ/0.25V	0.143	1.90
GCDB104MT470	47	M	1KHZ/0.25V	0.241	1.80
GCDB104MT560	56	M	1KHZ/0.25V	0.260	1.62
GCDB104MT680	68	M	1KHZ/0.25V	0.338	1.35
GCDB104MT820	82	M	1KHZ/0.25V	0.384	1.26
GCDB104MT101	100	M	1KHZ/0.25V	0.429	1.17
GCDB104MT121	120	M	1KHZ/0.25V	0.455	1.10
GCDB104MT151	150	M	1KHZ/0.25V	0.611	1.05
GCDB104MT181	180	M	1KHZ/0.25V	0.650	1.00
GCDB104MT221	220	M	1KHZ/0.25V	0.939	0.900
GCDB104MT271	270	M	1KHZ/0.25V	1.17	0.720
GCDB104MT331	330	M	1KHZ/0.25V	1.30	0.530
GCDB104MT391	390	M	1KHZ/0.25V	1.56	0.450
GCDB104MT471	470	M	1KHZ/0.25V	1.76	0.405
GCDB104MT681	680	M	1KHZ/0.25V	1.83	0.360

Electrical characteristics List
GCDB105 Series

PART No.	L(uH)	Tolerance	Test Condition	DCR (Ω)MAX	IDC (A)
GCDB105NT1R2	1.2	N	100KHZ/0.25V	0.0120	8.30
GCDB105NT1R5	1.5	N	100KHZ/0.25V	0.0140	8.30
GCDB105NT2R2	2.2	N	100KHZ/0.25V	0.0160	7.50
GCDB105NT3R3	3.3	N	100KHZ/0.25V	0.0195	6.50
GCDB105NT3R9	3.9	N	100KHZ/0.25V	0.0221	6.00
GCDB105NT4R7	4.7	N	100KHZ/0.25V	0.0280	5.50
GCDB105NT5R6	5.6	N	100KHZ/0.25V	0.0300	4.50
GCDB105NT6R8	6.8	N	100KHZ/0.25V	0.0360	4.90
GCDB105MT100	10	M	1KHZ/0.25V	0.0510	4.00
GCDB105MT120	12	M	1KHZ/0.25V	0.0520	3.60
GCDB105MT150	15	M	1KHZ/0.25V	0.0570	3.30
GCDB105MT180	18	M	1KHZ/0.25V	0.0590	3.10
GCDB105MT220	22	M	1KHZ/0.25V	0.0820	2.90
GCDB105MT270	27	M	1KHZ/0.25V	0.0870	2.70
GCDB105MT330	33	M	1KHZ/0.25V	0.0950	2.60
GCDB105MT390	39	M	1KHZ/0.25V	0.1820	2.20
GCDB105MT470	47	M	1KHZ/0.25V	0.1830	2.00
GCDB105MT560	56	M	1KHZ/0.25V	0.2050	1.80
GCDB105MT680	68	M	1KHZ/0.25V	0.2340	1.60
GCDB105MT820	82	M	1KHZ/0.25V	0.2470	1.40
GCDB105MT101	100	M	1KHZ/0.25V	0.3250	1.35
GCDB105MT121	120	M	1KHZ/0.25V	0.3500	1.20
GCDB105MT151	150	M	1KHZ/0.25V	0.4030	1.10
GCDB105MT181	180	M	1KHZ/0.25V	0.5270	1.00
GCDB105MT221	220	M	1KHZ/0.25V	0.6580	0.94
GCDB105MT271	270	M	1KHZ/0.25V	0.7570	0.80
GCDB105MT331	330	M	1KHZ/0.25V	0.7750	0.60
GCDB105MT391	390	M	1KHZ/0.25V	0.9360	0.55
GCDB105MT471	470	M	1KHZ/0.25V	1.30	0.54
GCDB105MT561	560	M	1KHZ/0.25V	1.40	0.49